



**FIBERGLASS
DUCT
TECHNICAL
INFORMATION**

PROJECT: _____
 LOCATION: _____
 ARCHITECT: _____
 ENGINEER: _____
 SALES ENGINEER: _____
 DATE: _____

www.underduct.com

info@monoxivent.com

309-794-1000

Page: UD-6

UnderDuct Fittings and Joints

Generally, for underslab installation, the duct will be installed in a graded trench with good drainage and on a 4" bed of pea gravel, with sand or pea gravel used as a backfill. The duct will be joined by an internal galvanized sheet metal sleeve held in place by sheet metal screws and then sealed with a UL listed duct sealer. A wrap of Monoxivent 6" wide polyethylene-backed pressure sensitive tape shall be placed over the joint, as well as the screw heads.

Because water infiltration can be a threat, UnderDuct manufactured with a resin rich veil on the OD. Watertight joints will be made using the wet lay-up method.

Manufacturer's installation instructions are to be followed. See separate sheets for wet lay-up method instructions. The system is to be leak tested prior to backfilling.

Fittings



Elbow, 90°



Elbow, 45°



Concentric Reducer

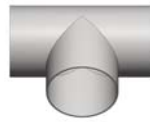

90° Tee

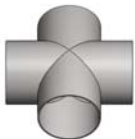

Cross



Eccentric Reducer



Lateral



Square to Round



Y Piece

Mechanical Joint

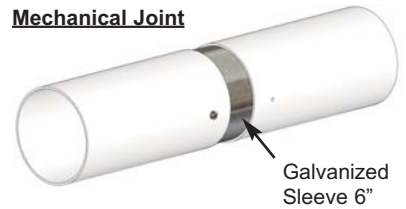

Galvanized Sleeve 6"

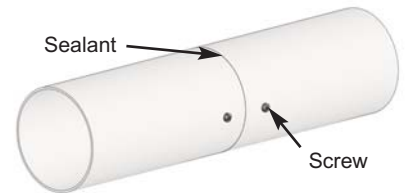

Sealant

Screw

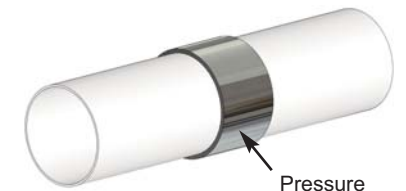

Pressure Sensitive Tape

Wet Joint

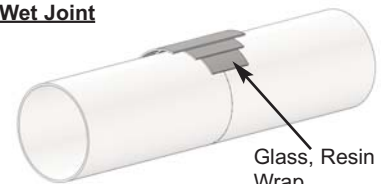

Glass, Resin Wrap